

**PART NO. 87325**

**Instruction Sheet**

## **TAURUS/TEMPO TOE WRENCH**

*This part should only be installed by personnel who have the necessary skill, training and tools to do the job correctly and safely. Incorrect installation can result in personal injury, vehicle damage and / or loss of vehicle control.*

***For Original Equipment adjusters only. Not for use on aftermarket kits.***

1. After determining rear toe change needed, loosen rear lower control arm bolt and nut at the inner frame bracket.
2. Adjust rear toe to manufacturer's specification by rotating the large hex shaped eccentric (located inside the frame bracket).
3. Tighten control arm nut to manufacturers specifications and complete front alignment.

**Always check for proper clearance between suspension components and other components of the vehicle.**

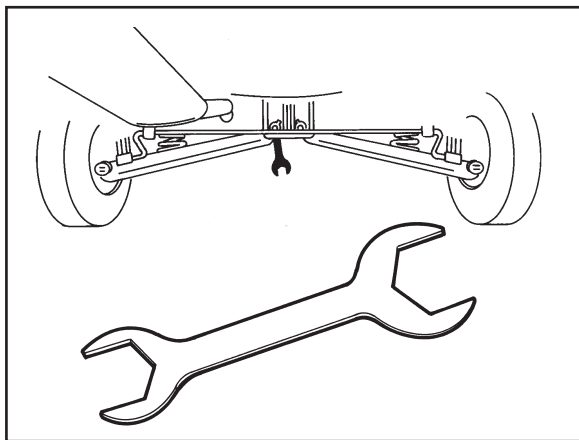

**Specialty  
Products  
Company®**

4045 Specialty Place • Longmont, CO 80504 • (303) 772-2103  
Fax: (303) 772-1918 • [www.specprod.com](http://www.specprod.com) • Email: [info@specprod.com](mailto:info@specprod.com)  
**Toll Free Technical Hot Line: 1-800-525-6505** Printed in the USA  
**For warranty information go to: [www.specprod.com/warranties](http://www.specprod.com/warranties)**

©2018 Niwot Corp. dba Specialty Products Co. • Form No. 87325INS • Rev. 3/18