



Instruction Sheet
JounceShock™ System Rear
 2003 - 2009 4Runner,
 2007 - 2009 FJ Cruiser

US Patent 7140601 B2

This part should only be installed by personnel who have the necessary skill, training and tools to do the job correctly and safely. Incorrect installation can result in personal injury, vehicle damage and / or loss of vehicle control.

Read instructions completely before beginning installation.

Required Tools:

- Metric sockets and wrenches
- Pry bar
- Torque wrench 100 lb-ft
- Vise
- Large channel lock pliers or pipe wrench
- Floor jack or lift w/ jack stands
- 1/4" Pin style spanner
- 1/8" hex key

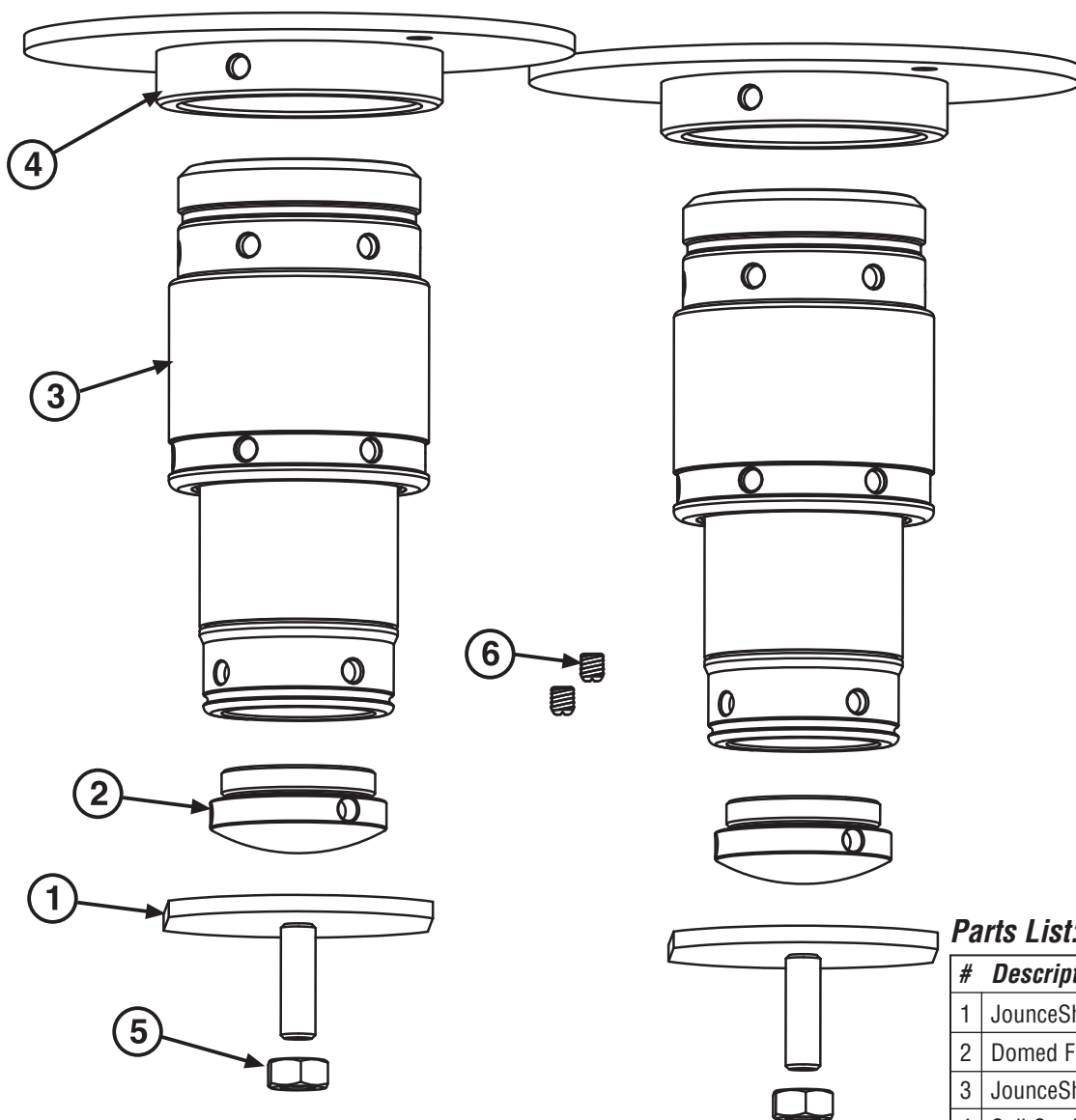

Parts List:

#	Description	Qty.
1	JounceShock Target Plate	2
2	Domed Foot	2
3	JounceShock, 1.5" Travel	2
4	Coil Carrier Mount	2
5	M10 Nut	2
6	1/4-20 x 5/16", Cup Point, Set Screw	2

Part No. 25784 Instruction Sheet

Rear JounceShock System - 2003 - 2009 4Runner, 2007 - 2009 FJ Cruiser - Continued

Installation process:

1. Confirm that you have all parts and tools required to complete job.
2. Safely raise vehicle per manufacturer's specifications and support rear axle on jack stands.
3. Remove lower shock bolts and pull shocks off of lower mounts.
4. Lower rear axle to un-load coil springs. Care must be taken to not overextend suspension, brake lines, or wiring running from axle to frame.
5. Thread cylinder end of 1.5" JounceShock into mount until it bottoms. Apply a small dab of medium strength thread locker (Blue Loctite) to the 1/4"-20 set screw and install into mount snug tight using 1/8" hex key. Install JounceShock unit into Coil Carrier Mount and tighten using 1/4" pin style spanner on JounceShock. (Use vise to hold Coil Carrier Mount.)
6. Thread Domed Foot into shaft end of JounceShock until it bottoms.
7. Remove coil spring and stock bump stop that is inside spring as seen in **FIGURE 1**.
8. Replace stock bump stop with JounceShock and Coil Carrier Mount assembly as shown in **FIGURE 2**.
9. Reinstall coil spring with JounceShock into vehicle.
10. Place JounceShock Target Plate into existing holes on axle coil mount as shown in **FIGURE 3**.
11. Apply small dab of medium hold thread locker (Blue Loctite) to supplied M10 Nut and thread onto stud on bottom of JounceShock Target Plate. Tighten using channel lock pliers to hold target plate while turning nut. (Follow all Loctite cure time instructions.)
12. Repeat installation steps 5-11 for opposite side of vehicle.
13. Lower vehicle onto coil springs. Ensure coil springs are seated properly.
14. Reinstall shocks and tighten fasteners to manufacturer's specifications.
15. Remove stock secondary bump stops from under frame rails. Finished system is shown in **FIGURE 4**.
16. Re-torque all fasteners after 100 miles.
17. Retain stock bump stops for the ability to return to stock configuration.

***For information on how to tune the JounceShocks, please refer to the instructions for the individual shocks:
http://www.spcalignment.com/instructions/25710-INS_WEB.pdf***

What to expect from your JounceShock system:

The JounceShock is the core of a secondary suspension system that dramatically increases the capacity of your vehicle's suspension. Most systems are designed such that the JounceShocks do not engage the suspension of your vehicle at ride height. Therefore, the system does not usually alter the ride height or on-road ride quality of your vehicle. When you have a heavy payload or take your vehicle off-road, your suspension will compress more and engage the JounceShocks. When the suspension engages the JounceShocks, you may hear the initial contact. This is normal and is an indication that the JounceShocks are being applied. When the vehicle is driven off-road you will notice a couple of performance gains. First, as you drive the vehicle over rough terrain it never feels as though the vehicle is bottoming. Also, you will realize that the vehicle moves up and down less, this is known as "Gross Vehicle Motion Control". These are changes caused by the characteristic exponential air spring curve and the critical damping of the JounceShock units. These changes significantly enhance the ability and durability of the vehicle, as well as the comfort level of the occupants. This added capacity can be misleading and care should be taken to learn the new limits of your vehicle without damage to the vehicle itself. For more discussion on JounceShock function and performance gains please visit our website at www.specprod.com

Figure 1

Remove coil spring and stock bump shock



Figure 3

Place JounceShock Target Plate into existing holes on axle coil mount

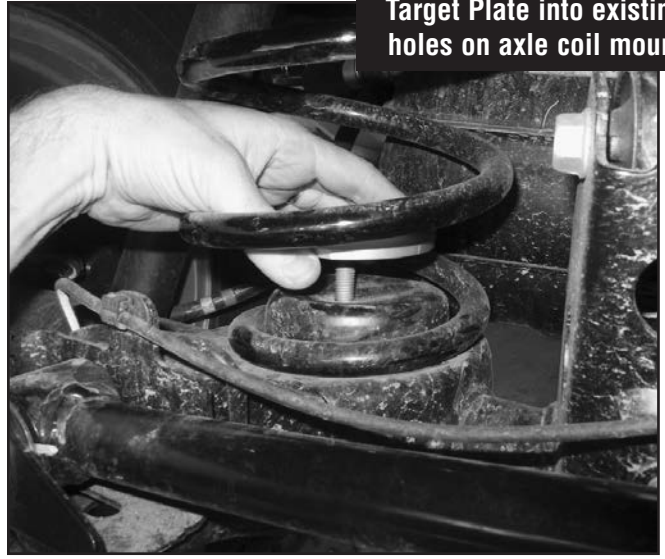

Figure 2

Replace stock bump stop with JounceShock and Coil Carrier Mount assembly



Figure 4

Remove stock secondary bump stops from under frame rails

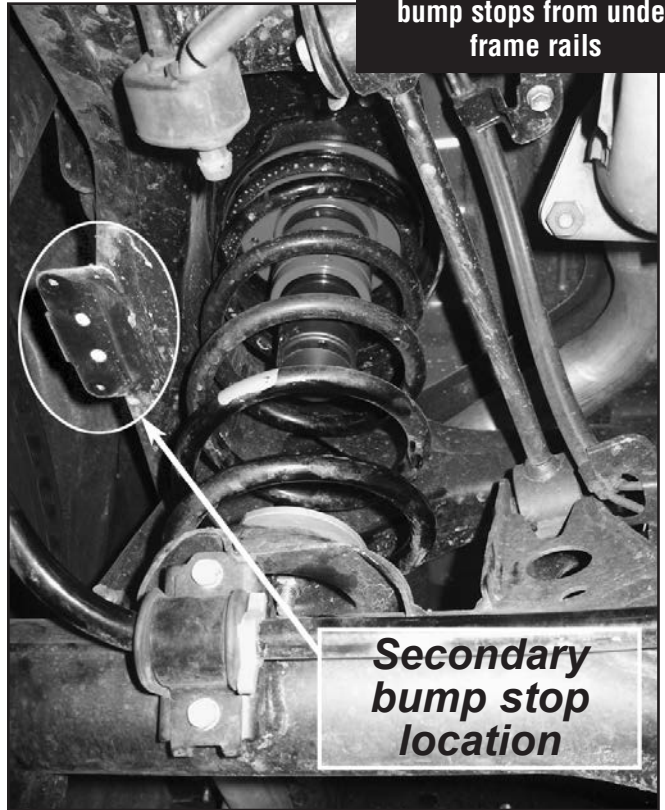

Part No. 25784 Instruction Sheet

Rear JounceShock System - 2003 - 2009 4Runner, 2007 - 2009 FJ Cruiser - Continued

There is no warranty stated or implied due to the inability to monitor the part's modification, installation, and use, except that Specialty Products Company warrants its products to be free from defects in material and workmanship for 90 days after purchase under normal use. In that case, parts returned must be determined by Specialty Products to be defective and Specialty Products's obligations under that warranty are solely limited to repairing or replacing, at its option, any part proven defective.

Final determination of the suitability of the parts for use contemplated by the buyer is the sole responsibility of the buyer. Specialty Products Company shall not be liable for any special, direct, indirect, incidental, or consequential damages that might be claimed as a result of the failure of any part, including claims for delay, loss of profits or labor. Specialty Products Company shall not be liable for any damage or injury to persons or property resulting from improper installation or misuse of any part subject to this warranty. There are no other warranties expressed or implied extending beyond those set forth above.



Specialty Products Company[®]

P.O. Box 923 • Longmont, CO 80502 • (303) 772-2103 • Fax: (303) 772-1918 • www.specprod.com • Email: info@specprod.com

ECN#1866

Toll Free Technical Hot Line: 1-800-525-6505

©2015 Niwot Corp. dba Specialty Products Co.[®] • Printed in U.S.A. • Form No. 98784 • Rev. 5/15